

STOLMA – Technische Details – Alukon Raff-E

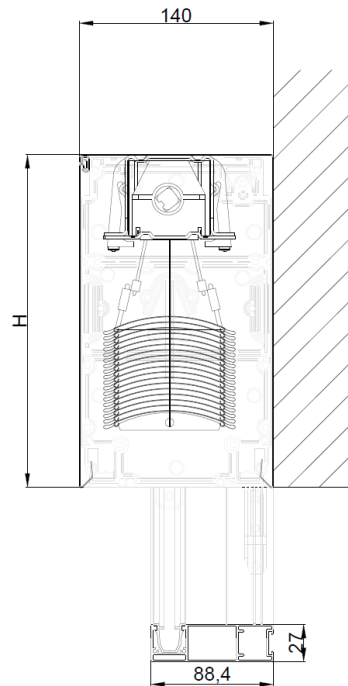

Aufbauhöhe Raff-E mit Motor

Kastenhöhe	Kastentiefe	Max. Elementhöhe inkl. Kasten	
		C80	Z90
200	140	1250	1750
240	140	2000	2500
300	140	3250	3500

C80 Lamelle

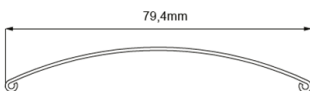

Z90 Lamelle

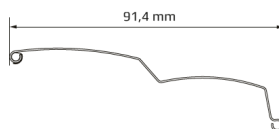

Putzträger 25 mm

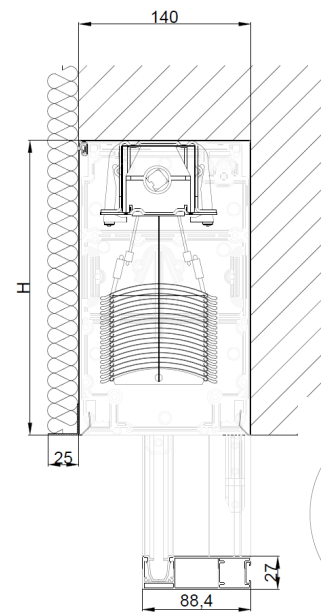

Führungsschiene

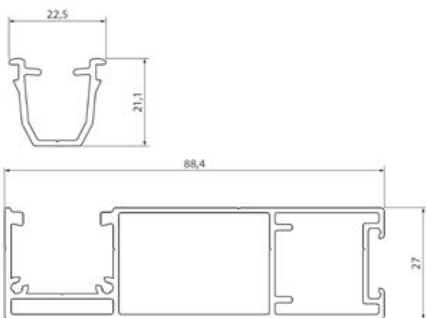

Führungsschiene MONOBLOK

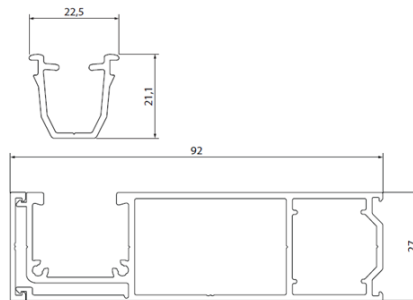

Montagebohrung

